

Dongguan Great Innovating Co.,Ltd.



Trusted
Healthcare
&
PPE
Supplier for you!

20 YEARS

total solutions to health care



Company profile

Dongguan Great Innovating Co.,Ltd. established in 1994, is a leading manufacturer of wide range of disposable medical products and PPE products. (Personal Protective Equipments Products) Over the past 20 years, **Great Innovating** has enjoyed unprecedented growth due to the large support of our valued customers.

With three large-scale, modernized production base in China, **Great Innovating** covers a wide range of medical non-woven disposables, PPE coveralls and dental plastics. **Great Innovating** has been distinguished with approval and certifications such as FDA (510K), ISO 9001:2000, ISO 13485:2003 and CE by TUV.

With 20 years of development and experience, **Great Innovating** now serves the following markets of Hospital, Clinics, Dental, Food Services, Industrial Field, Homecare, Government and Consumer markets. Geographically, **Great Innovating** provides its products to nearly every international marketplace with fast growing presence in USA, Canada, Europe, South America and majority of the Asian Countries.

We have well organized facilities and a highly professional train team staff with knowledgeable employees focused on our growing international operations.

We offer integrated support for our clients in manufacturing, outsourcing and developing new medical products. Furthermore, we focus on providing cost effective service, prompt response to inquiries, consolidation solution and offer the most competitive prices, with a focus on uncompromised quality.

We are pleased to offer you our high quality products and competitive pricing, with a commitment to excellent customer service. We are positioned to with our vast intelligence and resources to be your total sourcing solution in China.

Our goal is clear. We want to partner with you to offer cost savings, support and a partnership that will assist both our organization to excel in our business objectives and focused with you as leaders in the field.

- Leading Manufacturer of Medical and PPE Disposables
- Advance automated production and experience.
- About 20 years of professional manufacturing and trading experience.



[01]

.....

SURGICAL GOWNS MEETS EN13795



[06]

.....

AAMI PB70 ISOLATION GOWN



[15]

.....

PROTECTIVE COVERALLS



[17]

.....

SURGICAL DRAPES

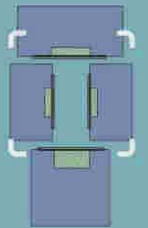

[21]

.....

CAPS, HOODS



[23]

.....

BOOT COVERS, SHOE COVERS



[25]

.....

PROFESSIONAL MASKS & RESPIRATORS



A smiling woman in a blue surgical cap and gown is the central focus of the image. She is in an operating room, with other medical staff in similar attire visible in the background. The lighting is bright and clinical.

AAMI PB70

Why are more hospitals and purchasing groups choosing **Great Innovating** for their all-around protection?

Our medical products provide the highest protection with the greatest comfort at the lowest cost.

Our medical apparel line includes generously sized footwear, protective headwear, gowns that meet AAMI PB70 requirements, protective multi-purpose gowns, a full range of protective coveralls and comfortable, colorful lab coats and lab jackets.

We know you rely on disposable apparel to keep your staff protected and comfortable. For this reason, we use the finest materials available for protection, offering the greatest level of comfort. We apply the highest quality standards to our products and in our manufacturing facilities.



TUV ISO 13485-2003 certified and FDA Registered,
manufacturing protective apparel for over 15 years.

SURGICAL GOWN BARRIER CLASSIFICATIONS

US MARKET AAMI PB70:2003 & EU MARKET EN13795



WHAT IS EN 13795 ?

EN 13795 is a norm that has been approved by CEN on September 6, 2004 and is acknowledged as the European standard that controls and confirms the crucial requirements of all medical devices such as surgical gowns, drapes and clean air suits, both disposable and non disposable textiles.

Parts of EN13795

1. Basic information for the manufacturers, converters and for the processors such as traceability processes and validation of all steps.

2. Testing methods that evaluate specifications explained on Part1.

For instance;

EN ISO 22610; resistance to wet microbial penetration

EN ISO 22612; resistance to dry microbial penetration etc.

3. Defining the minimum and maximum standards depending on the conditions of the surgical operations.



| EN 13795-2:2004 | |
|---------------------|---|
| EN ISO 22610:2006 | Resistance to wet microbial penetration |
| EN ISO 22612:2005 | Protection against infection agents |
| EN ISO 9073-10:2003 | Assessment of linting and particulate matter |
| EN 1174-2:1996 | Microbial cleanliness |
| EN 13938-1:1999-wet | Determination of bursting strength |
| EN 29073-3:1992-wet | Determination of the breaking strength and elongation |

1. Adjustable neckline on

gowns, colour-coated available for plus information.

2. Raglan or Set-in sleeves provides

different options for greater freedom of movement

3. Extra Long Cotton Knitted Cuffs

Latex-free, keeps the gloves tight and safe on surgeon's hand.

4. Ultrasonic welding on critical parts for excellent protection.

The technology of ultrasonic welding makes the jointing part seamless and faultless, which forms ultimate barrier to fluid and bacteria. Comparing with traditional sewing stitches, it makes the gown more protective and stronger.

5. The 5th Generation SMMMS fabric

Our SMS technology utilizes five layers of fabric to provide a high level of fluid repellency. This helps provide a barrier to blood, body fluids and pathogens, the fabric features three densely-packed meltblown layers sandwiched between two strong spunbond outer layers. Strategy raw material supplier PGI, Ahlstrom, SAAF.



6. Low-linting

All gowns are very low linting, minimizing the risk of introducing particles into the O.R.

7. Latex-Free

All gowns are latex free. All of our packaging is clearly labeled with latex-free symbol for added piece of mind.





High Performance Surgical Gown

GSG80
5-layer anti-static breathable SMMMS fabric with AR+AS Treatment

- High level anti-static treatment
- Excellent microbial barrier
- Excellent physical barrier to contaminants and fluids
- Stronger fabric with a matte finish, resistance to tears
- Softer fabric with comfort inside and outside
- Book fold is available
- Ultrasonic sealed seam or Three thread over-lock Serged seam



Raglan Sleeve



Ser-in Sleeve

High Performance Surgical Gown

Critical Zone Reinforced

- PE or Fabric internal strengthening to grant the maximum protection against possible blood and blood products contaminations.



◆PP+PE, SMS, Impregnated paper

All 3 kinds of reinforcement pads can be applicable for reinforced surgical gowns

This high performance nonwoven fabric is made by Reifenhauser IV line.

The new SMMMS fabric is available with antistatic and alcohol-repellent finishes. It delivers high fluid and particulate barrier and is soft, strong and low in lint. Compatible with ethylene oxide, steam, and gas plasma sterilization, it is available for AAMI PB70 Level 3 and EN 13795 High Performance.



Alcohol Repellent



Anti-Blood



Oil Repellent

APPLICATION



1PC/BAG,30PCS/CTN



Cat. I^a

Multiply Surgical Gown

GSG10
5-layer anti-static breathable SMMMS fabric:

- Excellent microbial barrier
- Excellent physical barrier to contaminants and fluids
- Stronger fabric with a matte finish, resistance to tears
- Softer fabric with comfort inside and outside
- Book folded.
- Sterile by ETO

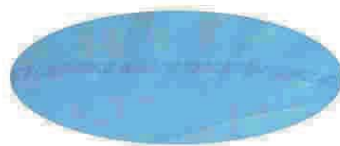

Ultrasonic sealed seam

Multiply Surgical Gown

Critical Zone Reinforced

- PE or Fabric internal strengthening to grant the maximum protection against possible blood and blood products contaminations.

Folding Steps:



A



B



C



D



E



F

APPLICATION



1PC/BAG,30PCS/CTN



Cat. I^a





Spunlace Basic Surgical Gown

GSG31

It is made of polyester reinforced cellulose nonwoven (Spunlace) with anti-static and fluid resistance. The extreme softness provide surgical gowns cloth-like feel and a good level of comfort for those who spend much of their day in a surgical gown. It keeps wearers cool and comfortable.

For light to moderate blood exposure, protecting surgeon, first assistance and scrub nurses. Earns AAMI Level 3 Protection and EN13795 with Reinforcement.

Features:

- Soft spunlace fabric (made of woodpulp and polyester)
- Fluid repellent
- Generous cut
- Velcro neck binding
- Book fold
- Sterile by ETO
- Ultrasonic sealed seam
- Critical zone reinforced optional

Spunlace Reinforced Surgical Gown

GSG51

PE or Fabric internal strengthening to grant the maximum protection against possible blood and blood products contaminations.

SUPERSOFT™ & MEDCROSS™

XL-XL



EN 13795 HP | AAMI 3

Made in China

L

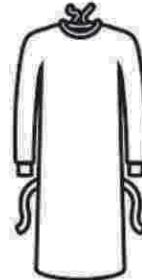

EN 13795 SP | AAMI 2

Made in China

APPLICATION



1PC/BAG,30PCS/CTN



Cat. I^a

SURGICAL GOWN BARRIER CLASSIFICATIONS

US MARKET AAMI PB70:2003 & EU MARKET EN13795



High Performance Surgical Gown

High Performance Reinforced Surgical Gown



Multiply Surgical Gown

Multiply Reinforced Surgical Gown



Spunlace Basic Surgical Gown

Spunlace Reinforced Surgical Gown

SMS Isolation Gown

GSG50

Level 1 and Level 2

Gowns made from multiply medium weight and lightweight SMS material. The Isolation Gowns meet the test requirements set forth by the Association for the Advancement of Medical Instrumentation (AAMI) PB70. Provide barrier protection based on AAMI guidelines and helps reduce the risk of contamination and transmission of infectious organisms which lead to HAIs.

Three-Layer SMS Fabric:

Outer layers-Cloth-like, yet tough and abrasion-resistant
Middle layer-Intricate web of microfibers that filters out many water-based liquids

Easy to wear

The tape tab neck closure makes these gowns easy to put on and take off.



Meets AAMI Levels 1 & 2

The gowns meet the Association for the Advancement of Medical Instrumentation (AAMI) PB70 standard, "Liquid barrier performance and classification of protective apparel and drapes intended for use in health care facilities."

Medium Weight Gown – Level 2

(protection against low levels of fluids)

Lightweight Gown – Level 1

(protection against minimal levels of fluids)

Low-linting

Because these gowns are made from polypropylene, they are low in lint.



LEVEL 2



LEVEL 1



APPLICATION



10PC/BAG, 50PCS/CTN



Cat. I^a



SMS Impervious Gown

Thumbs Up Fluid-Proof Breathable Gown is styled to prevent sleeves from sliding. Our least expensive impervious, breathable gown is offered in the highly successful Thumbs Up style with the convenient thumb loop preventing sleeves from sliding up when putting on gloves. Reinforced polypropylene-film offers breathability in addition to strength for extended wear periods.

Multi-ply material: The SMS material provides AAMI level 2 barrier.



Features:

1. Over-the-head neck style, open back, Heat seam provides high protection
2. Thumb loop wrists feature elastic for a good gown and glove fit
3. Apron-style neck enables gown to be placed on and off quickly
4. Individually folded and wrapped gowns in dispenser box

Package:

Specially folded and packaged in individual pouches. Includes dispenser box.

| Lightweight Multi-Ply Protection and Comfort Levels | | | |
|---|----------------|--------|------|
| | Good | Better | Best |
| Protection | [Progress bar] | | |
| Comfort | [Progress bar] | | |

LEVEL 2

Coated Impervious Gown

These gowns are made by PE coated PPSB fabric to help prevent strikethrough by fluids. The fabric is proved passing ASTM F1670 / 1671 for protection on blood / virus. Different AMMI level could be requested with different seams.

Poly-Coated PP: Provide excellent fluid-resistant protection.

Features:

1. Over-the-head neck style, open back, Heat seam provides high protection
2. Thumb loop wrists feature elastic for a good gown and glove fit
3. Apron-style neck enables gown to be placed on and off quickly
4. Individually folded and wrapped gowns in dispenser box

Package:

Specially folded and packaged in individual pouches. Includes dispenser box.



| Coated Protection and Comfort Levels | | | |
|--------------------------------------|----------------|--------|------|
| | Good | Better | Best |
| Protection | [Progress bar] | | |
| Comfort | [Progress bar] | | |

LEVEL 4

APPLICATION



15PC/BOX, 75PCS/CTN



Cat. I^a



Spunbonded Polypropylene Isolation Gown

These protective garments are available in single-layer spunbonded polypropylene for basic coverage or a tri-layer SMS fabric for increased fluid resistance. Each gown features a waist belt and latex-free elastic or knitted cuffs. Choose from either ties or a tape tab at the neck.

Besides, there are Open-back or Full-back optional styles.

1. Basic Polypropylene Isolation Gown
2. Made from lightweight, fluid-repelling polypropylene material
3. Generously sized for full coverage and flexibility
4. Styles available in classic neck and waist ties with elastic wrists or over-the-head with thumb loop wrists
5. Low in Lint

APPLICATION



10PC/BAG, 100PCS/CTN



Cat. J^a

Note: These gowns are constructed of a fabric that offers high fluid protection, yet due to seam construction, the gowns do not meet the AAMI PB70 Standard. For gowns that meet AAMI standards, please refer to front pages.

Standard Polyethylene-Coated Polypropylene Gown

Coated material Made from polypropylene and polyethylene coated together. Choose from two weights: medium weight and heavyweight.

Two options for wrists

The gowns feature comfortable latex-free knit or elastic wrists with neck and waist ties.

Protection from fluids

The gowns provide great fluid protection.

Low-linting

Polypropylene fabric makes these gowns low in lint.

APPLICATION



10PC/BAG, 100PCS/CTN



Cat. J^a





Classic Lab Jacket with Knit Collar and Knit Cuffs

The Classi Lab Coat is made from a fluid resistant multi-layer material to provide comfort and protection for everyday needs. Green Cross's disposable products are available with a five snap closure, reinforced pockets and a convenient loop inside for hanging. Enjoy our variety to fit your facility's needs.

Specifications

- | | |
|--------------------------------|----------------------------------|
| 1. Spun bonded polypropylene | 4. Plastic snaps |
| 2. Sewn pockets and seams | 5. Class One flammability rating |
| 3. Cotton knit cuff and collar | 6. Latex-free |

APPLICATION



10PC/BAG,50PCS/CTN



Cat. I^a



Scrub Suit



with Round Neck

The Scrub Suit offers non-transparent complete coverage made from breathable, fluid-resistant, multi-layer silk-like super soft SMS with anti-static treatment which helps protect them from fluid and bacteria. There are V-shape and Round-shape neck available, open short sleeve and pockets, which offer the wearer experience of regular clothes

APPLICATION



10PC/BAG,50PCS/CTN



Cat. I^a

Scrub Suit

with V-Shape Neck





Classic Polypropylene Lab Coat

The Standard Polypropylene Lab Coat is made from a fluid resistant multi-layer material to provide comfort and protection for everyday needs. Green Cross's disposable products are available with a five snap closure or zip or Velcro front, reinforced sleeve, back vent for extended wear and a convenient loop inside for hanging. Enjoy our variety to fit your facility's needs.

1. Knit cuffs.
2. Traditional collar.
3. Six-snap front closures.
4. Three reinforced pockets.
5. Back vent.
6. Neck loop for hanging.
7. White.



10PC/BAG, 50PCS/CTN



Cat. I^a

APPLICATION



Classic SMS Lab Coat

SMS is made of meltblown polypropylene sandwiched between two layers of spunbonded polypropylene. More fluid resistant than common spunbonded material, the multi-layered SMS apparel offers better protection for any level of exposure in a variety of health care situations.

Exposure Anticipated: Potential for moderate fluid contact and extended use. Sized generously and softer than regular spunbonded materials, latex-free SMS apparel drapes easily.

1. Knit cuffs.
2. Traditional collar.
3. Six-snap front closures.
4. Three reinforced pockets.
5. Back vent.
6. Neck loop for hanging.
7. White.



10PC/BAG, 50PCS/CTN



Cat. I^a

APPLICATION



Traditional Patient Gown

Traditional Patient Gown are made with soft SMS materials. Offers non-transparent complete coverage. There are non-sleeve type, short-sleeve type and long-sleeve type, always can satisfy your requirement to patient gowns. With ties at the neck and waist, which protects the wearer better. It is suitable for both staff and patient.

Features

1. Generously cut
2. Can be worn as a rear or front closure gown
3. Ideal for extended wear and multi-phase procedures
4. Waist ties are attached



10PC/BAG,50PCS/CTN



Cat. I^a



Patient Wrap Gown

Wrap Patient Gown are made with soft SMS materials. Offers non-transparent complete coverage. There are Kimono type, Robe type and 3-Armhole type, always can satisfy your requirement to patient gowns. With ties attached, which protects the wearer better.

Features

1. Generously cut
2. Ideal for extended wear and multi-phase procedures
3. Waist ties are attached



10PC/BAG,50PCS/CTN



Cat. I^a



Scrim Reinforced Tissue Gown

Scrim Reinforced Tissue Gown is made of 4ply or 3ply SCRIM Reinforced Tissue material provides fabric-like Excellent durability, modesty and comfort.

Features

1. Generously cut
2. Ideal for extended wear and multi-phase procedures
3. Provides comfort with modest coverage



10PC/BAG,100PCS/CTN



Cat. I^a



Patient Exam Cape

Extra large disposable exam vest features telemetry breast pockets, three sturdy snaps for improved privacy and vents on each side for stress cable exit. Disposable vest is made of non-woven SMS material.

Features

1. Soft, opaque, nonwoven material ensures patient privacy
2. Latex-free waistband provides optimal fit and comfort
3. Ideal for lower body plastic surgery exams
4. Liposuction, Leg Laser Treatments, Bikini Waxing, Tummy Tucks, Before and After Photos





PROTECTION



Product Info

Coverall

Protective coverall in breathable microporous laminated nonwoven fabric, with sealed seam.

- ▶ Seams entirely sealed with blue tape
- ▶ Hood with elastic border
- ▶ Knitted cuffs or elastic cuffs are optional
- ▶ Elastic band at ankle
- ▶ Wide armhole for a maximum wearability and comfort during usage
- ▶ Silicon-free
- ▶ No particle release
- ▶ White color



50PCS/CARTON SIZES: M/L/XL/XXL/XXXL



Cat. III^a



EN 13034 -Type 6
EN 13982-1 -Type 5
EN 14605 -Type 4



EN 1149



EN 1073-2



EN 14126



Back elastic band at waist, for a major body adherence



Adhesive strip zip cover, to grant an high level of waterproofness.

APPLICATION



Selecting the appropriate protective garment not only against to prevent injury, but may also help to prevent long-term occupational diseases. Your employees may put their health at risk. Therefore, they require protection that can be rely on and trusted.



Product Info

2000 Coverall

Protective coverall in Multiply SMMS nonwoven fabric.

- ▶ Bound stitched seam keep the performance of liquid resistance
- ▶ Hood with elastic border
- ▶ Knitted cuffs or elastic cuffs are optional
- ▶ Elastic band at ankle
- ▶ Wide armhole for a maximum wearability and comfort during usage
- ▶ Silicon-free
- ▶ No particle release
- ▶ White color



50PCS/CARTON SIZES: M/L/XL/XXL/XXXL

CE  Cat. III^a

 EN 13034 -Type 6
EN 13982-1 -Type 5

 EN 1149

 EN 1073-2

 EN 14126



Back elastic band at waist,
For a major body adherence



Adheslve strip zip cover to grant
an high level of waterproofness

APPLICATION





We offers an extensive surgical drape line. Our standard drape collection features a top-of-the-line SMS fabric, composed of five strong fiber layers for exceptionally high barrier strength. Made of 100% polypropylene, SMS drapes are soft and drapeable. Composed with the latest generation SMS technology, the SMS drapes have smaller fibers and a more uniform fiber lay-down.



Flat Drape

Code No. GCB-011
Size 6*60cm

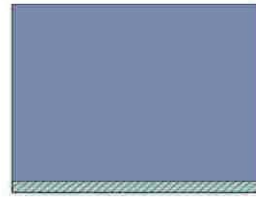

Flat Drape

Code No. GCB-012
Size 100*100cm with adhesive 5*100cm

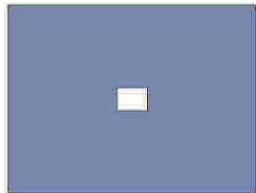

Fenestrated Drape

Code No. GCB-013
Size 60*60cm
Fenestration 10*10cm

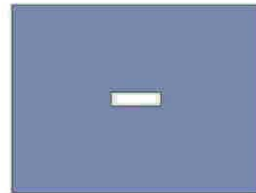

Fenestrated Drape

Code No. GCB-014
Size 80*80cm
Fenestration 17*6cm

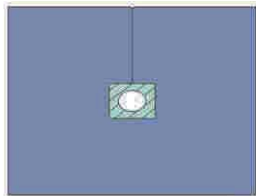

Procedure Drape

Code No. GCB-015
Size 90*120cm
Fenestration round \varnothing 6.5cm
Feature 15*15cm d/s tape around fenestration perforated from edge to centre

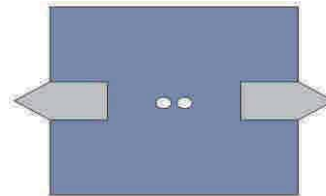

Ophthalmic Drape

Code No. GCB-016
Size 60*60cm
Fenestration two \varnothing 5cm with 10-10cm Incise
Feature Fluid pouch and support wire

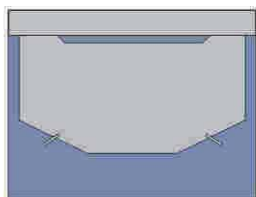

Head Drape

Code No. GCB-017
Size 109*85cm

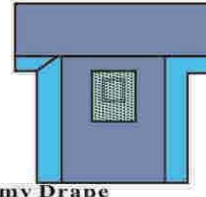

Laparotomy Drape

Code No. GCB-018
Size 260*312cm
Rinforcement 60*85cm
Feature 10*30.5cm fenestration with 18.6*37 Incise, d/s tape, side view panels

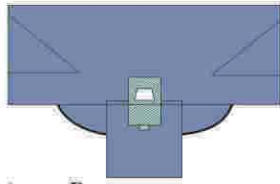

Laparotomy Drape

| | |
|---------------|----------------------------|
| Code No. | GCB-019 |
| Size | 325*260cm |
| Rminforcement | 40*75cm |
| Feature | Ladder-shaped fenestration |

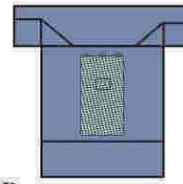

Extremity Drape

| | |
|---------------|---|
| Code No. | GCB-020 |
| Size | 310*335cm |
| Rminforcement | 760*165cm |
| Feature | 6.5cm expandable fenestration, tube holders |

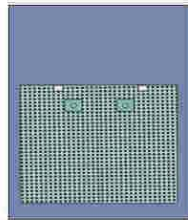

Extremity Drape

| | |
|--------------|---|
| Code No. | GCB-021 |
| Size | 210*325cm |
| Fenestration | 180*180cm |
| Feature | 6.5cm expandable fenestration, tube holders |

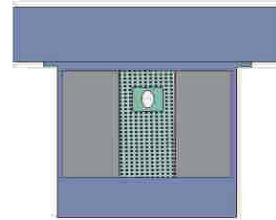

Hip Drape

| | |
|--------------|--|
| Code No. | GCB-022 |
| Size | 310*320cm |
| Fenestration | 52*160cm |
| Feature | expandable fenestrations, fluid pouch and support wire, tube holders |

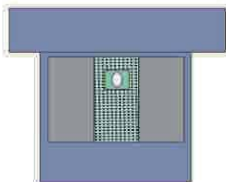

Hip Drape

| | |
|---------------|--|
| Code No. | GCB-023 |
| Size | 292*351cm |
| Reinforcement | 52*140cm |
| Feature | expandable fenestrations, fluid pouch and support wire |

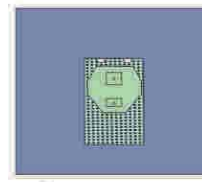

Arthroscopy Drape

| | |
|---------------|---|
| Code No. | GCB-024 |
| Size | 300*350cm |
| Rminforcement | 90*180cm |
| Feature | 5*7.5cm oval expandable fenestration, fluid pouch |

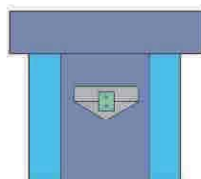

Arthroscopy Drape

| | |
|---------------|--|
| Code No. | GCB-025 |
| Size | 447*295cm |
| Rminforcement | 50*55cm |
| Feature | 6cm and 5cm expandable fenestrations, fluid pouch and support wire, side view panels |

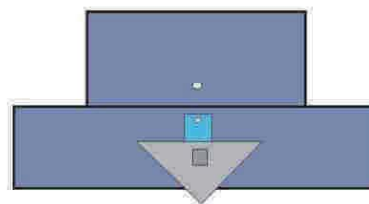

Tur Drape

| | |
|---------------|--|
| Code No. | GCB-026 |
| Size | 258*165cm |
| Rminforcement | 165cm |
| Feature | finger cor, pouch with mesh and drain port |

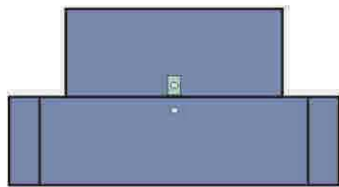

Tur Drape

| | |
|--------------|--|
| Code No. | GCB-027 |
| Size | 266*186cm |
| Fenestration | 6cm |
| Feature | finger cot, pouch with mesh and drain port |

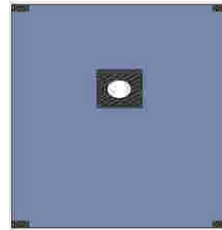

Brachial Drape

| | |
|----------|---|
| Code No. | GCB-028 |
| Size | 75*100cm |
| Feature | 7.5*9.5cm oval fenestration, with adhesive, d/s tape in corners |

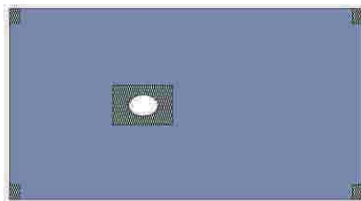

Brachial Drape

| | |
|----------|-------------------------------------|
| Code No. | GCB-029 |
| Size | 100*75cm |
| Feature | 7.5*9cm oval fenestration, d/s tape |

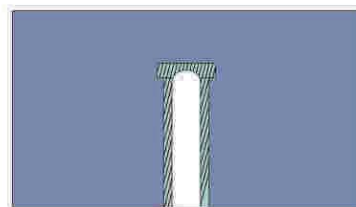

Split U Drape

| | |
|----------|-----------------------|
| Code No. | GCB-030 |
| Size | 150*200cm |
| Feature | arch15*93cm, d/s tape |

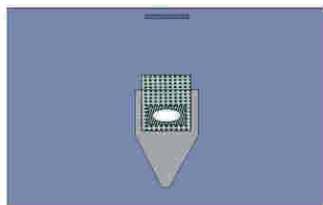

Craniotomy Drape

| | |
|---------------|--|
| Code No. | GCB-031 |
| Size | 245*256cm |
| Rminforcement | 48*74cm |
| Feature | 18*28cm oval fenestration with incise, fluid pouch |

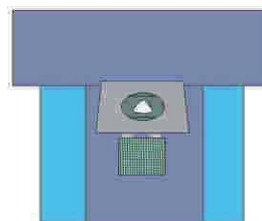

Caesarean Drape

| | |
|---------------|--|
| Code No. | GCB-032 |
| Size | 249*312cm |
| Rminforcement | 45*55cm |
| Feature | Oval fenestration with incise, fluid pouch with support wire, tube holders |

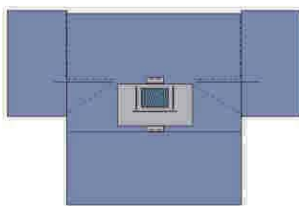

Caesarean Drape

| | |
|----------|--|
| Code No. | GCB-033 |
| Size | 343*310cm |
| Feature | fluid pouch with support wire and drain port, incise 38*28cm, tube holders |

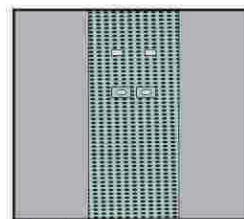

Angiography Drape

| | |
|---------------|---|
| Code No. | GCB-034 |
| Size | 210*370cm |
| Reinforcement | 82.5*370cm |
| Feature | two fenestrations square 10*10cm two 6.5cm with incise, side view panels |

BOUFFANT CAP

Polypropylene 10-16GSM

White/Blue/Green/Pink/Red Color

Size: 18-24"



1000PCS/CARTON



Cat. I^a



APPLICATION



PEAKED CAP

Polypropylene 10-16GSM

White/Blue/Green/Pink/Red Color

Peak Paper Size: 18-24"



1000PCS/CARTON



Cat. I^a



APPLICATION



SNOOD CAP

Side 60GSM + Peak 90GSM

White/Blue/Green/Pink/Red Color

Size: Universal



1000PCS/CARTON



Cat. I^a



APPLICATION



NYLON HAIR NET

Nylon 18GSM

White/Black Color

Size: 18-24"



1000PCS/CARTON



Cat. I^a



APPLICATION



HAIR BAND

Polypropylene With 4 elastics

White color

Size: L/XL



1000PCS/CARTON



Cat. I^a



APPLICATION



MOB CAP

Polypropylene, single or double elastics

Detective strip is optional

White/Blue/Green/Pink/Red/Black Color

Size: 18-24"



1000PCS/CARTON



Cat. I^a



APPLICATION



BEARD COVER

Polypropylene 10-16GSM

White/Blue/Green/Pink/Red Color

Size: L/XL



1000PCS/CARTON



APPLICATION



SURGICAL COVER

SMS 30-55GSM

White/Blue/Green Color

Size: Universal



1000PCS/CARTON



APPLICATION



NYLON HOOD

Nylon 18G

White color

Size: Universal



1000PCS/CARTON



APPLICATION



SMS Surgical Cap

1. Soft and absorbent SMS material, ventilated crown and adjustable ties or elastic band
2. Comfortable and Breathable
3. Latex-free



500PCS/CARTON



APPLICATION



Scrim Reinforced Surgical Cap Kaycel-like

- SRM - Scrim reinforced material, a paper-like absorbent material
Multi-Layer Polypropylene - Highly fluid-resistant, yet breathable
Spunlace - Extremely soft, comfortable and most absorbent



500PCS/CARTON



APPLICATION



SHOE COVER

CROSSGARD™

Microporous Laminated fabric

Elastic ankle SIZES: UNIVERSAL

500PCS/CARTON

CE  Cat. I^a



APPLICATION



SHOE COVER

HEAVY DUTY CPE

Ultrasonic heat seam

Elastic ankle SIZES: UNIVERSAL

500PCS/CARTON

CE  Cat. I^a



APPLICATION



SHOE COVER

ANKLE HIGH

Ultrasonic heat seam

Elastic ankle SIZES: UNIVERSAL

500PCS/CARTON

CE  Cat. I^a



APPLICATION



SHOE COVER

CPE/PE

CPE/PE 2.0-4.0 gr

Elastic ankle light blue color

Size: 15x36cm, 15x41cm

2000PCS/CARTON

CE  Cat. I^a



APPLICATION



SHOE COVER

CPE COATED PP

Weight 10gr

Elastic ankle light blue color

Size: UNIVERSAL

1000PCS/CARTON

CE  Cat. I^a



APPLICATION



SHOE COVER

PVC SOLE

Ultrasonic heat seam

Elastic ankle light blue color

Size: UNIVERSAL

500PCS/CARTON

CE  Cat. I^a



APPLICATION



BOOT COVER

MEDIUM WEIGHT CPE

Elastic ankle

SIZES: UNIVERSAL

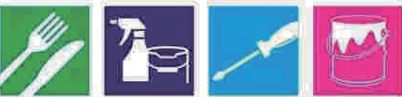

APPLICATION



BOOT COVER

HEAVY DUTY CPE

Elastic ankle White color

SIZES: UNIVERSAL



APPLICATION



BOOT COVER

CROSSGARD™

Microporous Laminated fabric 65gr

Elastic ankle SIZES: UNIVERSAL

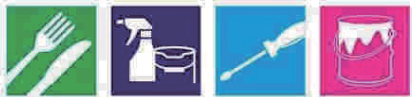
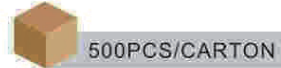

APPLICATION



BOOT COVER

MULTIPLY SMS

Elastic ankle

Size: L/XL



APPLICATION



BOOT COVER

MULTIPLY SMS

Anti-skid sole

Elastic ankle light blue color

Size: L/XL



APPLICATION



BOOT COVER

WITH PVC SOLE

Elastic ankle

Two elastic bands on leg

Size: L/XL



APPLICATION



510K Number

Enhanced Safety and Performance!

Great Innovating offers a wide variety of mask designs, fit and filtration to match the protection needs for each procedure or risk level. The Mask filtration guide makes it easy to select the level of filtration required, including ASTM Level 1, 2 and 3 and N95 particulate respiration. From minimum performance masks for dry, short procedures, to our maximum filtration mask, Isolator Plus, Great Innovating has the right mask for the task!

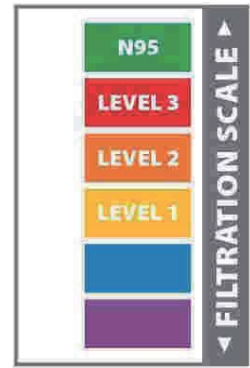

| | | | |
|---|--|--|---|
| <p>MAXIMUM FILTRATION</p> <p>Indicated for use when treating patients with airborne diseases such as TB or influenza.</p> <p>Meets CE 0121-In reference to EN 149: 2001 FFP2 NR</p> | | | <p>N95 Particulate Respirator</p> <ul style="list-style-type: none"> • NIOSH approved N95 Respirator. • Meets guidelines for TB exposure control • Resistance to penetration by synthetic blood: 160mmHg. |
| <p>ASTM LEVEL 3</p> <p>Ideal for procedures where heavy to moderate amounts of fluid, spray and/or aerosols are produced.</p> <p>Meets EN14683 Rating-Type IIR Standard.</p> | | | <p>Ultra Sensitive Earloop Technology</p> <ul style="list-style-type: none"> • BFE = 99.9% @ 3 microns. • PFE = 99.9% @ 0.1 micron. • Patent pending design with aluminum strip under chin for custom fit. • Fluid resistant outer layer. • White hypoallergenic inner cellulose layer. • Extra soft – will not link, tear or shred. • Free of chemicals, inks and dyes. • Extra-long aluminum nose piece. |
| <p>ASTM LEVEL 2</p> <p>Ideal for procedures where moderate to light amounts of fluid, spray and/or aerosols are produced.</p> <p>Meets EN14683 Rating-Type IIR Standard.</p> | | | <p>Procedural Surgical Mask</p> <ul style="list-style-type: none"> • BFE = 99.9% @ 3 microns. • PFE = 99.7% @ 0.1 micron. • Patent pending design with aluminum strip under chin for custom fit. • Fluid resistant outer layer. • Fluid resistant white inner layer. • Extra-long aluminum nose piece. |
| <p>ASTM LEVEL 1</p> <p>Ideal for procedures where low amounts of fluid, spray and/or aerosols are produced.</p> <p>Meets EN14683 Rating-Type II Standard.</p> | | | <p>Isolation Face Mask</p> <ul style="list-style-type: none"> • BFE = 98.4% @ 3 microns. • PFE = 98.5% @ 0.1 micron. • Patent pending design with aluminum strip under chin for custom fit. • Fluid resistant outer layer. • White tissue inner layer. • Extra-long aluminum nose piece. |
| <p>LOW PERFORMANCE</p> <p>Ideal as a comfortable substitute for earloop face masks, this mask is a simple physical barrier ideal for exams and visitations or for dry, short procedures that do not produce fluid, spray or aerosols.</p> | | | <p>Universal Face Mask</p> <ul style="list-style-type: none"> • BFE = 95% @ 3 microns. • PFE = 95% @ 0.1 micron. • Patent pending design with aluminum strip under chin for custom fit. • Fluid resistant outer layer. • White tissue inner layer. • Extra-long aluminum nose piece. |
| <p>MINIMUM PERFORMANCE</p> <p>Ideal as a simple physical barrier for exams, isolation and visitations or for dry, short procedures that do not produce fluid, spray or aerosols.</p> | | | <p>Molded Mask</p> <ul style="list-style-type: none"> • PFE = 98.7% @ 4.2 microns. • Splash resistant barrier. • Flared edge prevents irritation. • Soft, flexible nose piece. |
| <p>Comfortable 3D Performance</p> <p>Ideal as a comfortable substitute for earloop face masks, this mask is a simple physical barrier ideal for exams and visitations or for dry, short procedures that do not produce fluid, spray or aerosols.</p> | | | <p>3D Mask</p> <ul style="list-style-type: none"> • BFE = 98.4% @ 3 microns. • PFE = 98.5% @ 0.1 micron. • Patent pending design with aluminum strip under chin for custom fit. • Fluid resistant outer layer. • White tissue inner layer. • Extra-long aluminum nose piece. |

Dongguan Great Innovating Co.,Ltd.
 No.2, Muchang street, Shilong town
 Dongguan city, Guangdong, 523000, China
 Tel/WhatsApp/Wechat: 0086-18575285875
 Skype: greatingluis@hotmail.com
 E: luis@greatingmedical.com
 www.greatingmedical.com

